

## 10-Key RF Remote Controller

Model No.: R1/R2/RU4/RU8

1, 4, 8 zone dimming/10-key/Wireless remote 30m distance/CR2032 battery/Magnet stuck fix



R1  
1 Zone Dimming



R2  
1 Zone CCT



RU4  
4 Zone Dimming



RU8  
8 Zone Dimming

CE RoHS LVD RED

### Features

- Apply to single color or dual color LED controller.
- Each remote can match one or more receiver.
- CR2032 battery powered.
- Operate with LED indicator light.
- Magnet on the back which can be easily stuck on back holder or any metal surfaces.

### Technical Parameters

Input and Output	
Output signal	RF(2.4GHz)
Working voltage	3VDC(CR2032)
Working current	< 5mA
Standby current	< 2μA
Standby time	2 years
Remote distance	30m(Barrier-free space)

Environment	
Operating temperature	Ta: -30°C ~ +55°C
IP rating	IP20

Safety and EMC	
EMC standard (EMC)	ETSI EN 301 489-1 V2.2.3 ETSI EN 301 489-17 V3.2.4
Safety standard(LVD)	EN 62368-1:2020+A11:2020
Radio Equipment(RED)	ETSI EN 300 328 V2.2.2
Certification	CE,EMC,LVD,RED

Warranty	
Warranty	5 years

Weight	
Net weight	0.040kg
Gross weight	0.064kg

### Mechanical Structures and Installations

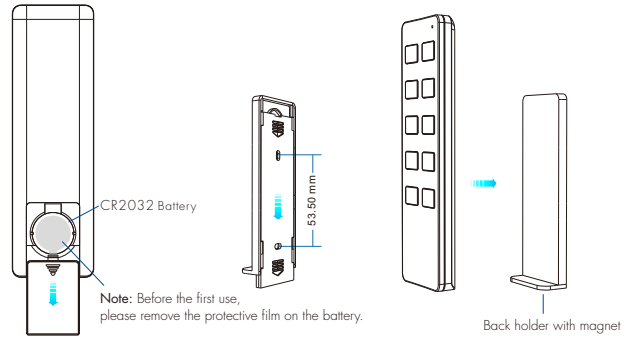
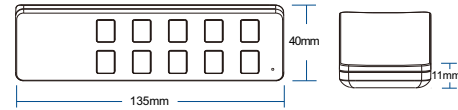

To fix the remote, three options are offered for selection:

- Option 1: stuck the remote on any metal surfaces directly.  
 Option 2: fix the remote' back holder on the wall with two screws.  
 Option 3: adhere the remote' back holder to the wall with paster.

### Match Remote Control (two match ways)

End user can choose the suitable match/delete ways. Two options are offered for selection:

#### Use the controller's Match key

**Match:**  
 Short press match key, immediately press on/off key (single zone remote) or zone key (multiple zone remote) on the remote.  
 The LED indicator fast flash a few times means match is successful.

**Delete:**  
 Press and hold match key for 5s to delete all match,  
 The LED indicator fast flash a few times means all matched remotes were deleted.

#### Use Power Restart

**Match:**  
 Switch off the power, then switch on power, repeat again.  
 Immediately short press on/off key (single zone remote) or zone key (multiple zone remote) 3 times on the remote.  
 The light blinks 3 times means match is successful.

**Delete:**  
 Switch off the power, then switch on power, repeat again.  
 Immediately short press on/off key (single zone remote) or zone key (multiple zone remote) 5 times on the remote.  
 The light blinks 5 times means all matched remotes were deleted.

## Key function

### • R1 1 zone dimming remote

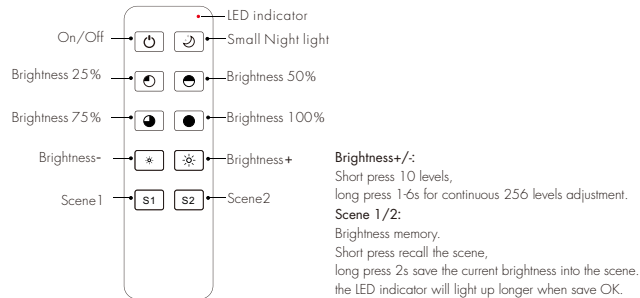

### • R2 1 zone CCT remote

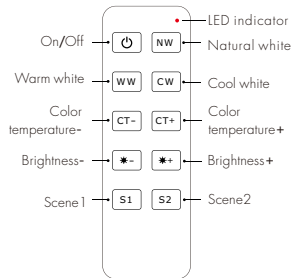

**Color temperature+/-:**  
Short press 11 levels, long press 1-6s for continuous 256 levels adjustment.

**Brightness+/-:**  
Short press 10 levels, long press 1-6s for continuous 256 levels adjustment.

**Scene 1/2:**  
Short press recall the scene, long press 2s save the current color into the scene. the LED indicator will light up longer when save OK.

### • RU4 4 zone dimming remote

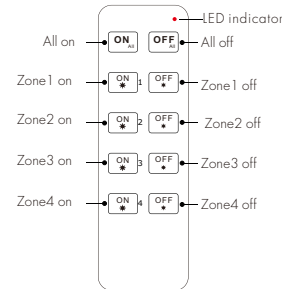

**All on:** Turn on all 4 zone light.

**All off:** Turn off all 4 zone light.

**Zone 1-4 on:**

Short press turn on zone light, long press 1-6s increase brightness continuously.

**Zone 1-4 off:**

Short press turn off zone light, long press 1-6s decrease brightness continuously.

### • RU8 8 zone dimming remote

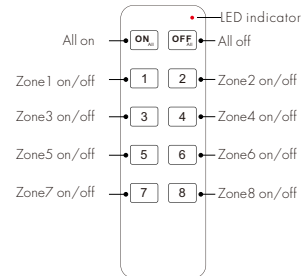

**All on:** Turn on all 8 zone light.

**All off:** Turn off all 8 zone light.

**Zone 1-8 on/off:**

Short press turn on/off zone light, long press 1-6s increase or decrease brightness continuously.

## Safety information

1. Read all instructions carefully before you begin this installation.
2. When installing battery, pay attention to the battery positive and negative polarity. A long time without the remote control, remove the battery. When remote distance becomes smaller and insensitive, replace the battery.
3. If no response from the receiver, please re-match the remote.
4. Gently handle remote, beware of falling.
5. For indoor and dry location use only.